



LMP 331

Screw-In Transmitter

Stainless Steel Sensor

accuracy according to IEC 60770:
standard: 0.35 % FSO
option: 0.25 % / 0.1 % FSO

Nominal pressure

from 0 ... 100 mbar up to 0 ... 40 bar

Output signals

2-wire: 4 ... 20 mA
3-wire: 0 ... 20 mA / 0 ... 10 V
others on request

Special characteristics

- ▶ pressure port G 3/4" flush
- ▶ excellent accuracy
- ▶ small thermal effect
- ▶ excellent long term stability



Optional versions

- ▶ accuracy 0.1% FSO IEC 60770
- ▶ IS-version: Ex ia = intrinsically safe for gases and dusts
- ▶ SIL 2 application according to IEC 61508 / IEC 61511
- ▶ different electrical connections
- ▶ customer specific versions
e. g. special pressure ranges

The screw-in transmitter LMP 331 has been designed for continuous level measurement and is characterized by an excellent performance and a robust construction. The modular construction allows the user the highest possible flexibility in the adaption of LMP 331.

Optional features like e.g. an intrinsically safe version or a functionally safe version (SIL 2) increase the advantages when launching and realizing projects for plants and systems.

Preferred areas of use are

-  Plant and Machine Engineering
-  Energy Industry
-  Environmental Engineering
(water – sewage – recycling)



LMP 331

Stainless Steel Screw-In Transmitter

Technical Data

Input pressure range															
Nominal pressure gauge	[bar]	0.10	0.16	0.25	0.40	0.60	1	1.6	2.5	4	6	10	16	25	40
Level	[mH ₂ O]	1	1.6	2.5	4	6	10	16	25	40	60	100	160	250	400
Overpressure	[bar]	0.5	1	1	2	5	5	10	10	20	40	40	80	80	105
Burst pressure ≥	[bar]	1.5	1.5	1.5	3	7.5	7.5	15	15	25	50	50	120	120	210
Vacuum resistance		P _N ≥ 1 bar: unlimited vacuum resistance P _N < 1 bar: on request													
Output signal / Supply															
Standard		2-wire: 4 ... 20 mA / V _S = 8 ... 32 V _{DC}									SIL-version: V _S = 14 ... 28 V _{DC}				
Option IS-version		2-wire: 4 ... 20 mA / V _S = 10 ... 28 V _{DC}									SIL-version: V _S = 14 ... 28 V _{DC}				
Options 3-wire		3-wire: 0 ... 20 mA / V _S = 14 ... 30 V _{DC} 0 ... 10 V / V _S = 14 ... 30 V _{DC}													
Performance															
Accuracy ¹		standard: nominal pressure < 0.4 bar: ≤ ± 0.5 % FSO nominal pressure ≥ 0.4 bar: ≤ ± 0.35 % FSO option 1: nominal pressure ≥ 0.4 bar: ≤ ± 0.25 % FSO option 2: for all nominal pressures: ≤ ± 0.1 % FSO													
Permissible load		current 2-wire: R _{max} = [(V _S - V _{S,min}) / 0.02 A] Ω current 3-wire: R _{max} = 500 Ω voltage 3-wire: R _{min} = 10 kΩ													
Influence effects		supply: 0.05 % FSO / 10 V load: 0.05 % FSO / kΩ													
Long term stability		≤ ± 0.1 % FSO / year at reference conditions													
Response time ²		2-Leiter: ≤ 10 msec 3-Leiter: ≤ 3 msec													
¹ accuracy according to IEC 60770 – limit point adjustment (non-linearity, hysteresis, repeatability) ² with optional accuracy 0,1 % FSO the response time is 200 msec															
Thermal effects (Offset and Span)															
Nominal pressure P _N	[bar]	≤ 0.40									> 0.40				
Tolerance band	[% FSO]	≤ ± 1									≤ ± 0.75				
in compensated range	[°C]	0 ... 70									-20 ... 85				
Permissible temperatures															
Permissible temperatures		medium: -40 ... 125 °C electronics / environment: -40 ... 85 °C storage: -40 ... 100 °C													
Electrical protection															
Short-circuit protection		permanent													
Reverse polarity protection		no damage, but also no function													
Electromagnetic compatibility		emission and immunity according to EN 61326													
Mechanical stability															
Vibration		10 g RMS (25 ... 2000 Hz)									according to DIN EN 60068-2-6				
Shock		500 g / 1 msec									according to DIN EN 60068-2-27				
Explosion protection (only for 4 ... 20 mA / 2-wire)															
Approvals DX19-LMP 331		IBExU 10 ATEX 1068 X / IECEx IBE 12.0027X zone 0: II 1G Ex ia IIC T4 Ga zone 20: II 1D Ex ia IIIC T 85°C Da													
Safety technical maximum values		U _i = 28 V, I _i = 93 mA, P _i = 660 mW, C _i ≈ 0nF, L _i ≈ 0 μH, the supply connections have an inner capacity of max. 27 nF opposite the housing													
Permissible temperature for medium		in zone 0: -20 ... 60 °C with p _{atm} 0.8 bar bis 1.1 bar in zone 1 or higher: -20 ... 70 °C													
Conneting cables (by factory)		cable capacitance: signal line/shield also signal line / signal line: 160 pF/m cable inductance: signal line /shield also signal line / signal line: 1 μH/m													
Materials															
Pressure port		stainless steel 1.4404 (316L)													
Housing		stainless steel 1.4404 (316L)													
Seals		standard: FKM option: EPDM others on request													
Diaphragm		stainless steel 1.4435 (316L)													
Media wetted parts		pressure port, seals, diaphragm													

LMP 331

Stainless Steel Screw-In Transmitter

Technical Data

Miscellaneous	
Optionally SIL 2 application	according to IEC 61508 / IEC 61511
Current consumption	signal output current: max. 25 mA signal output voltage: max. 7 mA
Weight	approx. 200 g
Installation position	any ³
Operational life	> 100 x 10 ⁶ cycles
CE-conformity	EMC Directive: 2014/30/EU
ATEX Directive	2014/34/EU

³ Pressure transmitters are calibrated in a vertical position with the pressure connection down. If this position is changed on installation there can be slight deviation in the zero point for pressure ranges $P_N \leq 1$ bar.

Pin configuration

Electrical connections	ISO 4400	Binder 723 (5-pin)	M12x1 / metal (4-pin)	field housing	cable colours (IEC 60757)
Supply +	1	3	1	IN +	wh (white)
Supply -	2	4	2	IN -	bn (brown)
Signal + (only for 3-wire)	3	1	3	OUT +	gn (green)
Shield	ground pin	5	4	⊥	gnye (green-yellow)

Wiring diagrams

2-wire-system (current)

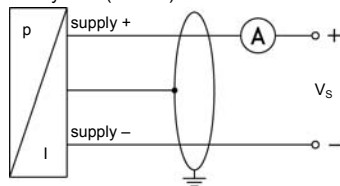

3-wire-system (current/voltage)

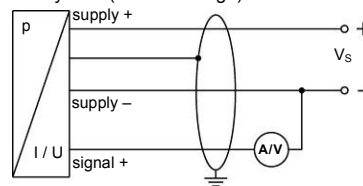

Electrical connections (dimensions in mm)

standard

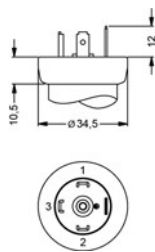

ISO 4400 (IP 65)

option

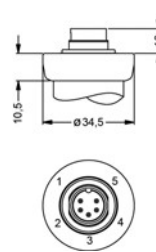

Binder Series 723 5-pin (IP 67)

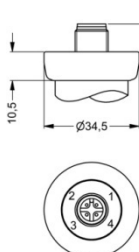

M12x1 4-pin (IP 67)

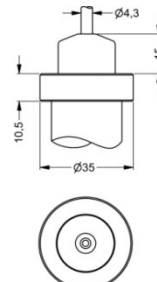

cable outlet with PVC cable (IP 67)⁴

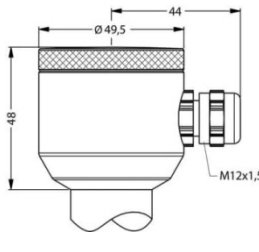

compact field housing (IP 67)

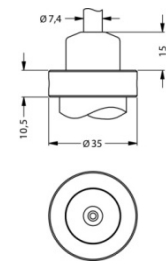

cable outlet, cable with ventilation tube (IP 68)⁵

⁴ standard: 2 m PVC cable (without ventilation tube, permissible temperature: -5 ... 70 °C)

⁵ different cable types and lengths available, permissible temperature depends on kind of cable

Mechanical connection (dimensions in mm)

standard

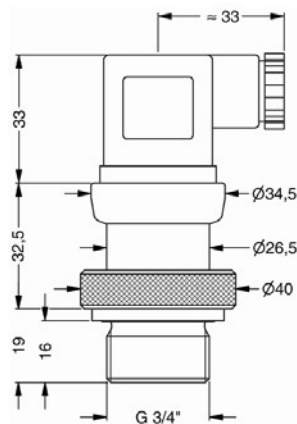

G3/4" flush (DIN 3852) with ISO 4400

standard for SIL and SIL Ex version⁶

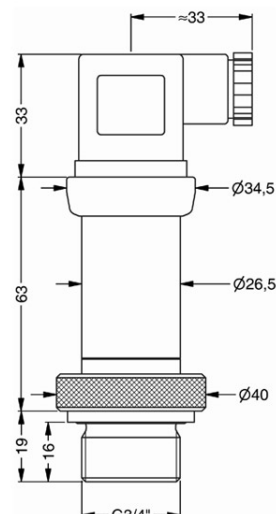

G3/4" flush (DIN 3852) with ISO 4400

⁶ not in combination with the accuracy 0.1%

Ordering code LMP 331

LMP 331

--	--	--	--	--	--	--	--	--	--	--	--	--	--	--	--	--	--	--	--	--

Pressure																				
	in bar	4	3	0																
	in mH ₂ O	4	3	1																
Input	[mH ₂ O]	[bar]																		
	1	0.10																		
	1.6	0.16																		
	2.5	0.25																		
	4	0.40																		
	6	0.60																		
	10	1.0																		
	16	1.6																		
	25	2.5																		
	40	4.0																		
	60	6.0																		
	100	10																		
	160	16																		
	250	25																		
	400	40																		
	customer																			consult
Pressure port																				
	Stainless steel 1.4404 (316L)																			
	customer																			consult
Diaphragm																				
	Stainless steel 1.4435 (316L)																			
	customer																			consult
Output																				
	4 ... 20 mA / 2-wire																			
	0 ... 20 mA / 3-wire																			
	0 ... 10 V / 3-wire																			
	Intrinsic safety 4 ... 20 mA / 2-wire																			
	SIL2 4 ... 20 mA / 2-wire																			
	SIL2 with Intrinsic safety 4 ... 20 mA / 2-wire																			
	customer																			consult
Seals																				
	FKM																			
	EPDM																			
	customer																			consult
Electrical connection																				
	Male and female plug ISO 4400																			
	Male plug Binder series 723 (5-pin)																			
	Cable outlet with PVC cable ¹																			
	Cable outlet ²																			
	Male plug M12x1 (4-pin) / metal																			
	Compact field housing stainless steel 1.4305																			
	customer																			consult
Accuracy																				
	standard for P _N ≥ 0.4 bar																			
	standard for P _N < 0.4 bar																			
	option 1 for P _N ≥ 0.4 bar																			
	option 2																			
	customer																			consult
Special version																				
	standard																			
	customer																			consult

Prices EXW Thierstein, excluding package

¹ standard: 2 m PVC cable without ventilation tube (permissible temperature: -5 ... 70 °C), others on request
² cable with ventilation tube (code TR0 = PVC cable), different cable types and lengths available, price without cable
³ not in combination with SIL